

TOP DECK

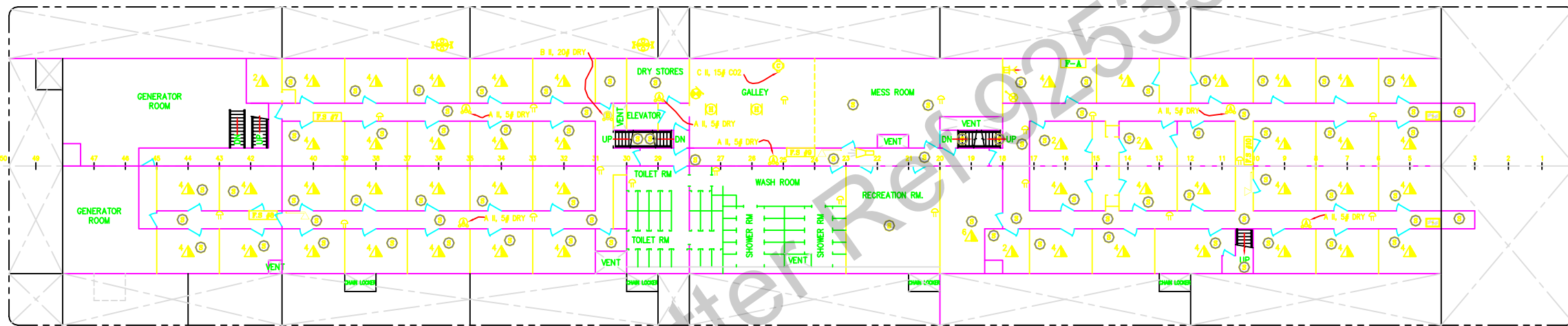

QUARTERS DECK

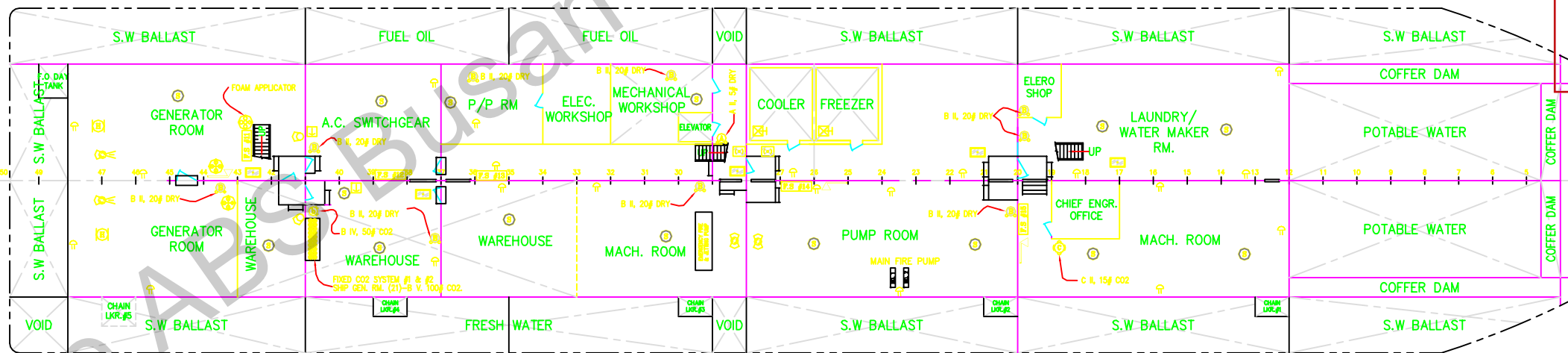

TANK TOP

| QTY | SYSTEM | DESCRIPTION |
|-----|--|-------------|
| 7 | TYPE A. SIZE II (5 Lbs. DRY CHEMICAL) | |
| 14 | TYPE B. SIZE II (20 Lbs. DRY CHEMICAL) | |
| 1 | TYPE B. SIZE IV (75 Lbs. CO ₂) | |
| 2 | TYPE B. SIZE V (50 Lbs. CO ₂) | |
| 23 | TYPE B. SIZE V (100 Lbs. CO ₂) | |
| 9 | TYPE C. SIZE II (15 Lbs. CO ₂) | |
| 2 | 20 Lbs. DRY CHEMICAL (SPARE) | |
| 3 | 20 Lbs. CO ₂ (SPARE) | |
| 1 | 10 Lbs. CO ₂ (SPARE) | |
| 10 | FIRE AXE | |
| 7 | METAL BOX (FAN SHUTDOWN PUSHBUTTON SINGLE STATION - W/ BREAK GLASS) | |
| 1 | MASTER VENT SHUT DOWN W/ THREE BUTTONS | |
| 3 | CO ₂ BOTTLE RELEASE | |
| 6 | FIRE STATIONS WITH INTERNATIONAL SHORE CONNECTION WITH DUAL PURPOSE TYPE NOZZLES | |
| 9 | FIRE STATIONS WITH DUAL PURPOSE TYPE NOZZLES | |
| 5 | GENERAL ALARM BELL | |
| 5 | GENERAL ALARM BELL RINGER | |
| 2 | CO ₂ ALARM SIREN | |
| 2 | FREEZER & REFRIGERATOR RINGER SW. | |
| 1 | FREEZER & REFRIGERATOR BELL | |
| 102 | SMOKE DETECTOR | |
| 4 | HEAT DETECTOR | |
| 12 | BREAKING GLASS | |
| 1 | MAIN FIRE ALARM PANEL (IN OFFICE) | |
| 1 | REPEATER PANEL (IN TOWER) | |
| 2 | SIREN W/ROTATING LIGHT | |
| 2 | SIREN | |
| 1 | TRANSCIVER | |
| 2 | FIRE MONITOR | |
| 2 | DRY POWER (50 Kg) PORTABLE EXTINGUISHERS | |
| 2 | CO ₂ 45kg PORTABLE EXTINGUISHERS | |
| 2 | FIRE FIGHTING SUIT, CRASH BOX | |
| 1 | FOAM APPLICATOR 45 LTR | |
| 2 | MANUAL CALL POINT | |
| 2 | PORTABLE FOAM EXTINGUISHER (9 LITERS) | |
| 1 | 45 LTR FOAM SEMI-PORTABLE EXTINGUISHERS | |

| LIFE SAVING EQUIPMENT LEGEND | | | |
|------------------------------|--------|--|------------------------------|
| NOR. REQ'D | SYMBOL | DESCRIPTION | U.S.C.G. APPROVAL NO. |
| 202 | ▲ | LIFE PRESERVERS: ATLANTIC PACIFIC MFRG. CORP. FIG. 4103, ONE REQ'D FOR EACH BUNK STORED IN QUARTERS. | 160.002/6/1 |
| 6 | ○ | RING BUOYS: ATLANTIC PACIFIC MFRG. CORP. FIG. 8401 - 50'-0" OF 3/8" MANILA ROPE W/EACH BUOY. | 160.050/17/3 |
| 3 | ○ | RING BUOYS W/WATERLIGHTS: ATLANTIC PACIFIC MFRG. CORP. FIG. 8401 - SEA LIGHT ENGR. CO. W/ 50'-0" OF 3/8" MANILA ROPE W/EACH BUOY. | 160.050/17/3 161.001/1/1 |
| 2 | ○ | RING BUOYS W/WATERLIGHTS: ATLANTIC PACIFIC MFRG. CORP. FIG. 8401 - SEA LIGHT ENGR. CO. W/ 90'-0" OF 3/8" POLYPROPYLENE ROPE W/EACH BUOY. | 160.050/17/3 161.001/1/1 |
| 20 | LLR | SOLAS (74/96) 25 PERSONS INFLATABLE LIFERAFT MODE KHA-25. | 160.051/27/0 |
| 19 | ▲ | SPARE RAFT PRESERVERS: SAME AS ▲ STORED IN LOCKER AFT. PK.18 - STBD SIDE. | 160.002/6/1 |
| 1 | R.B. | MARINE SAFETY EQUIPMENT CORP. 12.0'x4.425'x1.92' 4 PERSON REINF. FIBERGLASS PLASTIC LIFERAFT. OAR PROPELLED, FITTED W/ LIFELINES, ROWLOCKS, BUILT IN FOAM FILLED BUOYANCY UNITS, HANDRAILS, GRABRAILS, DRAIN FITTING & LIFTING SHOULDER(S)-3 C-C) EQUIP. W/ 2 LIFE PRESERVERS, 4-8 ROWING OARS, 1 SET WOODEN RIDGEPOLLS & SPREADERS, 1 LIFERAFT COVER NO. 6 CANVAS, FIRE, WATER & WEATHER RESISTANT. | 160.035/A39/2 161.001/1/1 |

CREW COMPLEMENT : 229
REGISTRY : VANUATU

REVIEWED
Details of this review are as indicated in the ABS Letter



RADIO ROOM

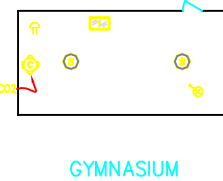

GYMNASIUM

| REV. | DESCRIPTION | DATE | BY |
|------|---|---------|----------|
| 4 | AS FITTED (DWS COMMENT DATED 23.7.2012) | 23/7/12 | SHJEE |
| 3 | AS FITTED (DWS COMMENT DATED 12.4.2011) | 18/4/11 | B.S.KANG |
| 2 | AS FITTED (ABS COMMENT DATED 30.1.09) | 18/2/09 | CK/CHEN |
| 1 | AS FITTED (ABS COMMENT DATED 30.1.09) | 30/1/09 | CK/CHEN |
| 0 | FOR APPROVAL | 21/1/09 | CK/CHEN |

| | |
|----------|--|
| OWNER | HYUNDAI HEAVY INDUSTRIES CO. LTD. |
| VESSEL | HYUNDAI 289 |
| TITLE | FIRE & SAFETY PLAN |
| BUILDER | LEVINSTON SHIPBUILDING CO. ORANGE, TEXAS |
| APPROVED | HULL NO. 679 |
| CHECKED | DRG NO. T-8-B-35 |
| DRAWN | CLASS AMERICAN BUREAU OF SHIPPING |
| SCALE | 3/32" TO 1'-0" |
| | DATE 18/04/2011 (REDRAWN) |

SEABOOK ENGINEERING PTE LTD
Navis Engineering Consultants & Engineers